



Main features

- Temperature limits:
 - 40 ... + 350° C for type T
 - 40 ... + 750° C for type J
 - 40 ... + 900° C for type E
 - 40 ... + 1000° C for type K
 (see table for sheath diameters)
- Tolerance:
 - IEC standard 584.2/Class 1:
 - for type T: $\pm 0,5^{\circ} \text{C}$ (- 40 ... + 125° C)
 - $\pm 0.004 [t]$ ($t > + 125^{\circ} \text{C}$)
 - for type J, E, K: $\pm 1.5^{\circ} \text{C}$ (- 40 ... + 375° C)
 - $\pm 0.004 [t]$ ($t > + 375^{\circ} \text{C}$)
- Mineral insulated (MgO) thermocouple element and continuous metal sheath
- Application versatility

MODELS

TC6M A
without fitting

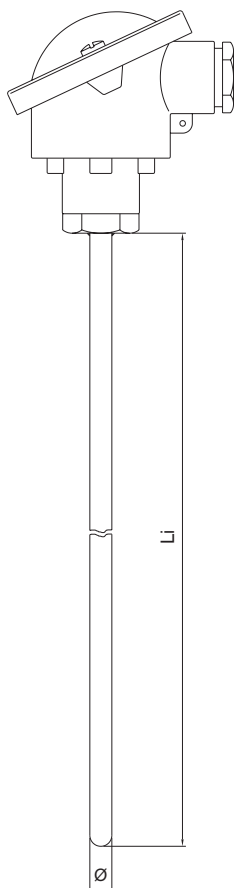

TC6M B
with adjustable
compression fitting

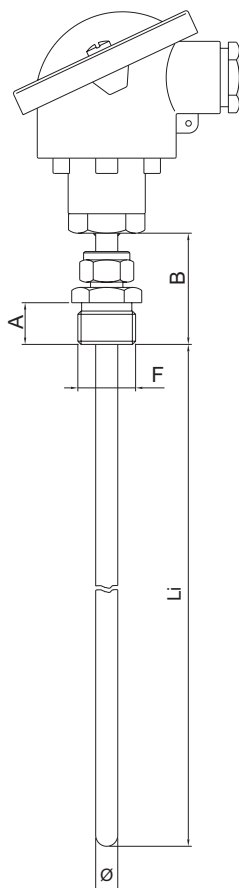

TC6M D
with welded fitting
under the head

