



Main features

- Temperature limits: - 40 ... + 600° C
- Tolerance: UNI 7937, IEC 751 standards:
 $\pm 0.15^\circ\text{C}$ a 0°C for class A (1/2 DIN)
 $\pm 0.30^\circ\text{C}$ a 0°C for class B (1 DIN)
 $\pm 0.10^\circ\text{C}$ a 0°C for class 1/3 DIN
- Ceramic insulation of sensor, PT100 at 0°C
- Application versatility

MODELS

TR6 A
without fitting

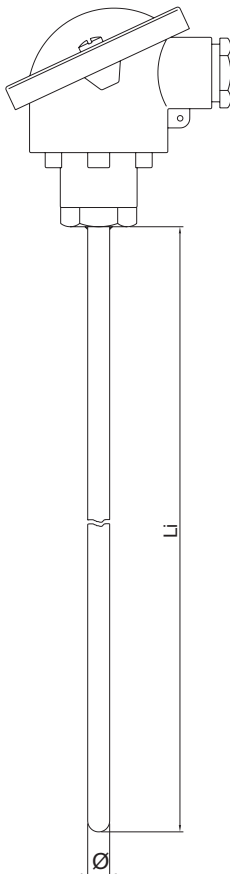

TR6 B
with adjustable
compression fitting

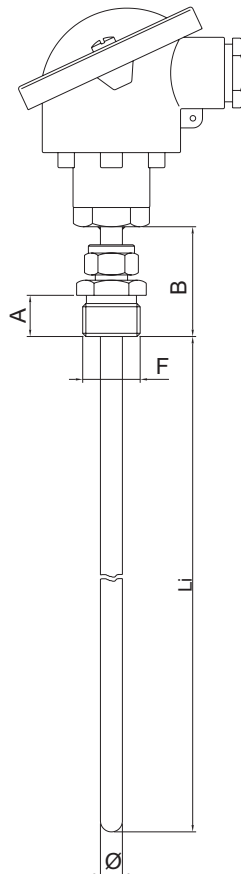

TR6 C
with welded fitting

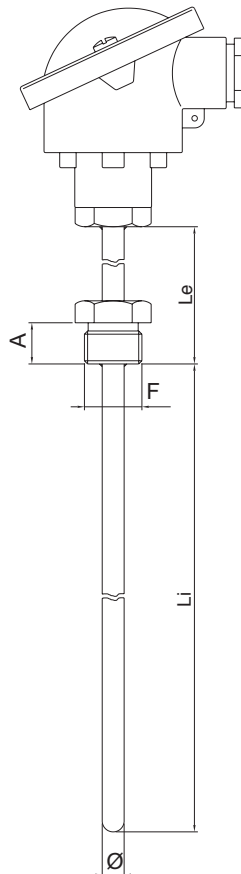

TR6 D
with welded fitting
under the head

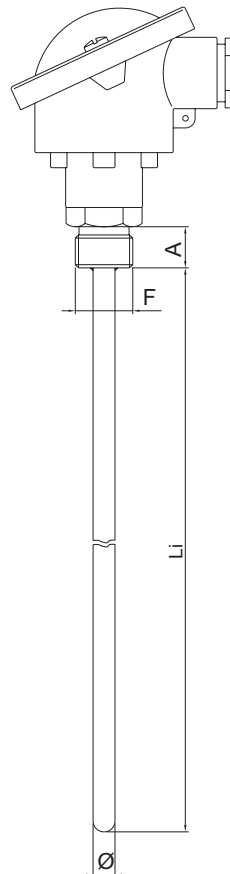

TR6 E
with female fitting
and welded ring

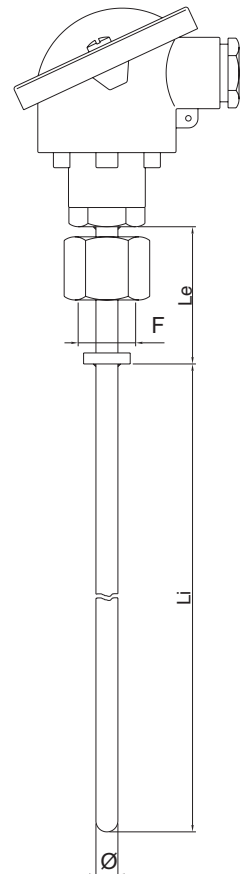

ORDER CODE

CODE

T R 6 | | | | | | | | | | | 0 0 0 X | | | | | X | | | | | X |

Model	
Without fitting	A
With adjustable compression fitting	B
With welded fitting	C
With welded fitting under the head	D
With female fitting and welded ring	E *

(*) Available with 1/2" GAS thread only

Element + Nr. of Wires	
Single 2 wires	1
Single 3 wires	2
Double 2 wires	3
Double 3 wires	4
Single 4 wires	5

Precision Class	
PT100 class A (1/2 DIN)	A
PT100 class B (1 DIN)	B
PT100 class (1/3 DIN)	C

Connection Head	
Mignon	A*
DIN J	B**
DIN B	C
DIN BUS	E
EEX d IIC 2GD	F
CEAA	H

(*) Available with single 2-wire element only
 (**) Not available with double 3-wire element

Sheath Material	
AISI 304	A
AISI 310	B
AISI 316	C
INCONEL 600	F

Sheath Diameter (mm)	
5	H*
6	I
8	J
10	K
12	L

(*) Not available with double 3 wire element

Connection Thread *		
1/8" GAS	"A"= 10mm	A
1/4" GAS	"A"= 12mm	B
3/8" GAS	"A"= 15mm	C
1/2" GAS	"A"= 15mm	D
1/8" NPT		G
1/4" NPT		H
3/8" NPT		I
1/2" NPT		J

(*) To be shown for B, C, D, E models only

Connection Material *	
Nickel-Plated Brass	1**
300 series stainless steel	2

(*) To be shown for B,C,D,E models only
 (**) Available for TR6B model only

Sheath Tip	
Drilled	F
NOT Drilled	0

MOUNT (F)	Mod. B		Mod. C e D
	A (mm)	B (mm)	A (mm)
G 1/8	10	35	10
G 1/4	12	35	12
G 3/8	15	40	15
G 1/2	15	40	15
1/8 NPT	11	35	11
1/4 NPT	16	40	16
3/8 NPT	16	40	16
1/2 NPT	20	45	20

Certificates	
A	Conformity Report

LENGTHS AND ACCESSORIES

Li = Immersion Length (mm)	
Standard Length	from 50 to 1000mm with 50mm step

Le = Extension Length (mm) *	
Standard Length	from 35 to 200mm with 10mm step

(*) Available for TR6C and TR6E models only

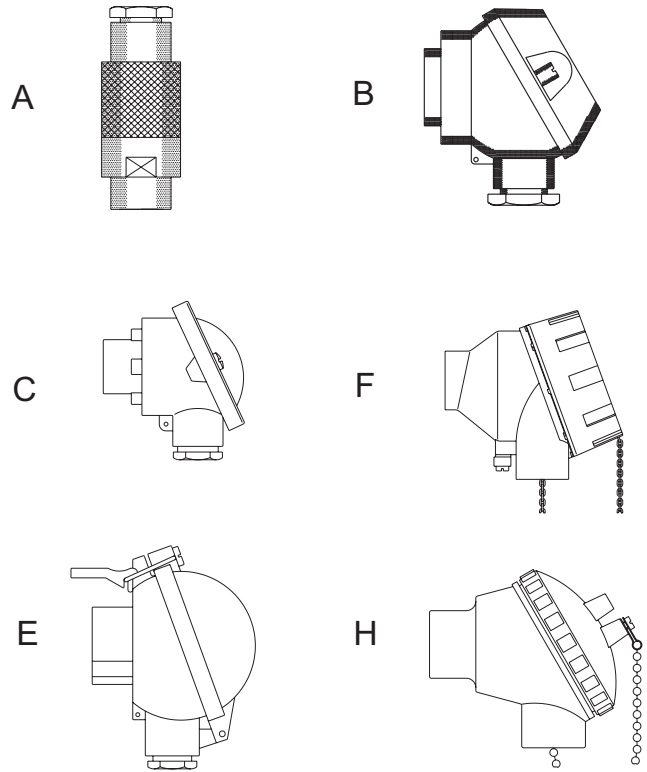

Availability of Mounts /Sheathing Diameter					
MOUNT(F)	ø5	ø6	ø8	ø10	ø12
G 1/8	x	x	-	-	-
G 1/4	x	x	-	-	-
G 3/8	x	x	x	x	-
G 1/2	x	x	x	x	x
1/8 NPT	x	x	-	-	-
1/4 NPT	x	x	x	-	-
3/8 NPT	x	x	x	x	-
1/2 NPT	x	x	x	x	x

GEFRAN spa reserves the right to make any kind of design or functional modification at any moment without prior notice

GEFRAN

GEFRAN spa
 via Sebina, 74 - 25050 PROVAGLIO D'ISEO (BS) - ITALIA
 ph. 0309888.1 - fax. 0309839063
 Internet: <http://www.gefran.com>
www.gefranonline.com

DTS_TR6_12-2015_ENG